



Date: 15/02/2019 **Author:** Craig Reeves **Project:** Littleton Street, Riverwood, Anzac Day Ceremony
Client: Club Rivers **Contact:** Meagan Ringwood **Phone:** 95333144
Plan Number : 1221/19

Comments:

This plan was designed by Craig Reeves of Sydney Traffic Control in accordance with Australian Standards and the RMS's Traffic Control on Worksite Handbook Version 4.0. The plan is designed for the safe closure of Littleton Street, Riverwood for an Anzac Day Ceremony. During the street fair detours will be in place. Residents living in Littleton Street have been informed and access will be limited on the day. Certified Traffic Controllers will be on site to implement and monitor this TCP. Sydney Traffic Control holds no responsibility for this TCP unless Sydney Traffic Control employees are used to implement and monitor this TCP. All traffic control plans are copyright/property of Sydney Traffic Control and are not transferable unless authorized by Sydney Traffic Control. Any question please contact Craig Reeves of Sydney Traffic Control on 80681844 or 0488793639.

NSW Transport Roads & Maritime Services
 Prepare a Work Zone Traffic Management Plan
 Card No: 0040529982
 This qualification enables you to prepare Traffic Management Plans and conduct inspections on Traffic Management Plans.
 CRAIG REEVES
 Expiry Date: 19/04/2020



SIGNED BY CRAIG REEVES
Craig Reeves
DATE: 15/02/2019

Legend www.invarion.com

- 🚦 traffic light
- 🚧 Speed Hump
- 🚧 Cone
- 👤 sign single
- 🚧 T2-4 road closed
- 🚧 T5-1 (L) detour (L)
- 🚧 T5-1 (R) detour (R)
- 🚧 T2-Q02a road closed ahead T2-Q02a
- 🚧 T1-6 detour ahead
- 🚧 TC1712 REDUCE SPEED TC1712
- 🚧 T1-200-2* traffic controller ahead symbolic day (yellow)
- 🚧 T1-32 T1-32 side road closed
- 🚧 Traffic Control Vehicle
- 👤 Traffic Controller

Manifest

- 1 x Crosswalk
- 7 x Cone
- 4 x traffic controller
- 2 x T2-4 road closed
- 5 x T5-1 (L) detour (L)
- 5 x T5-1 (R) detour (R)
- 1 x T5-1* detour (S)
- 2 x T2-Q02a road closed ahead T2-Q02a
- 6 x T1-6 detour ahead
- 4 x TC1712 REDUCE SPEED TC1712
- 4 x T1-200-2* traffic controller ahead symbolic day (yellow)
- 4 x T1-32 T1-32 side road closed

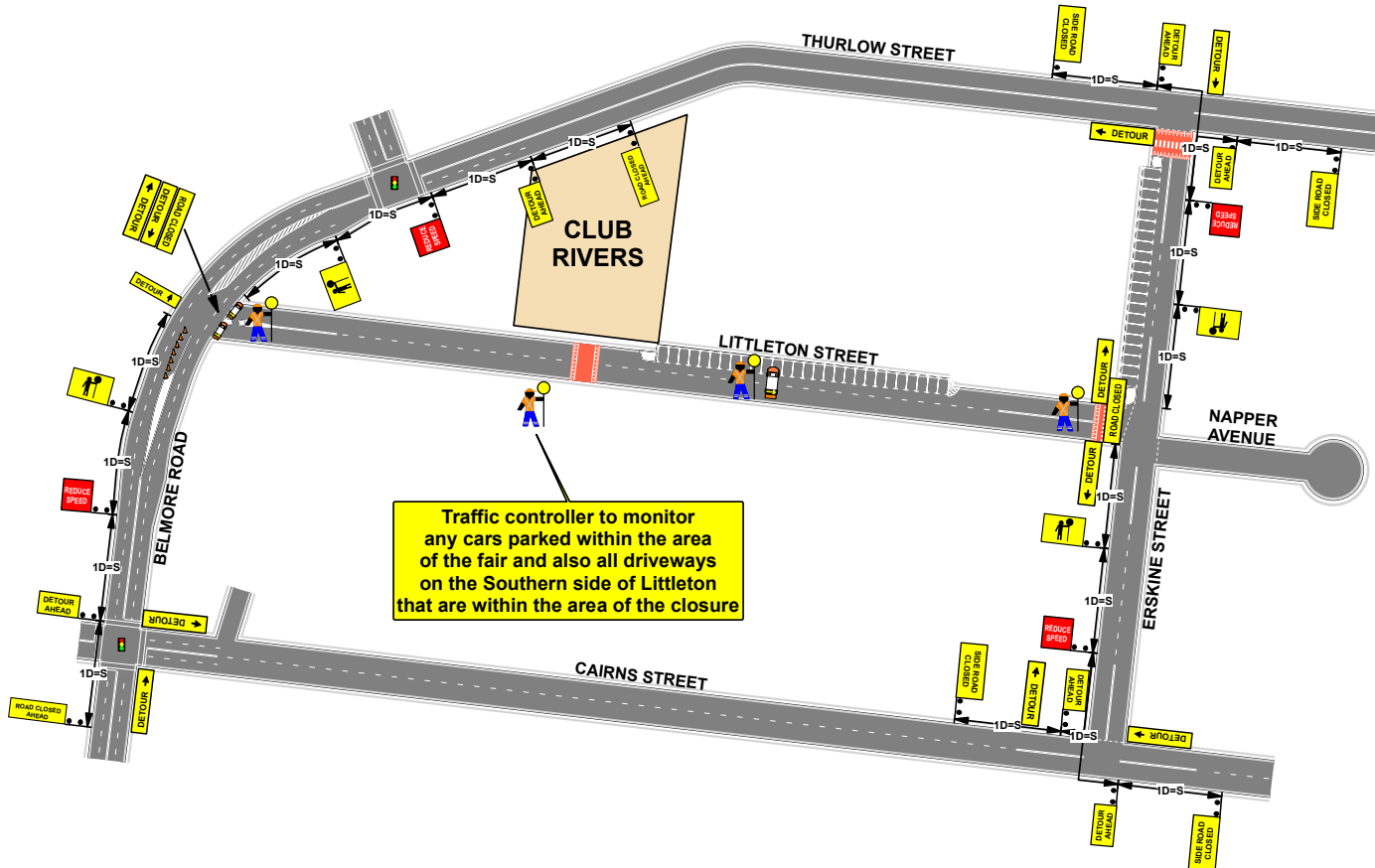

PLAN NOT TO SCALE

All advanced warning signs to be spaced as per RMS Roadwork on Worksite Handbook 1 x Distance = Speed.